

INDEX OF SHEETS

1. TITLE PAGE
2. TYPICAL SECTIONS
3. EARTHWORKS SHEET
- 5-10. PLAN AND PROFILE SHEETS

STATE OF VERMONT AGENCY OF TRANSPORTATION



PROPOSED IMPROVEMENT TOWN OF RANDOLPH COUNTY OF ORANGE VERMONT ROUTE 14

BEGINNING AT A POINT ON VT. ROUTE 14 6.645 MILES NORTH OF THE
BETHEL-RANDOLPH TOWN LINE AND EXTENDING NORTHERLY 0.219 MILES.
LENGTH OF ROADWAY 1055 FEET = 0.200 MILES
LENGTH OF BRIDGE 100 FEET = 0.019 MILES
LENGTH OF PROJECT 1155 FEET = 0.219 MILES
THIS PROJECT CONSISTS OF THE REPLACEMENT OF BRIDGE 39
OVER WHITE RIVER WITH NECESSARY APPROACHES.

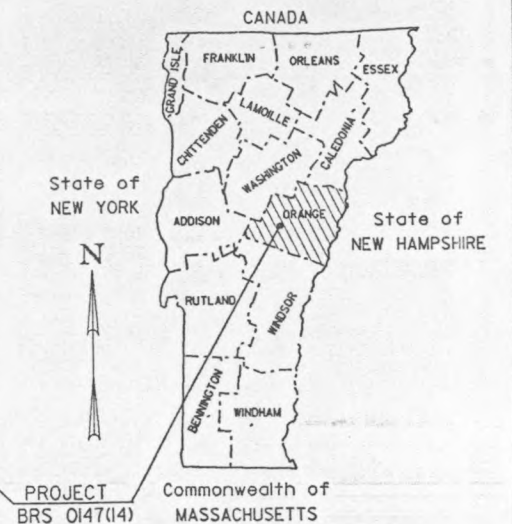
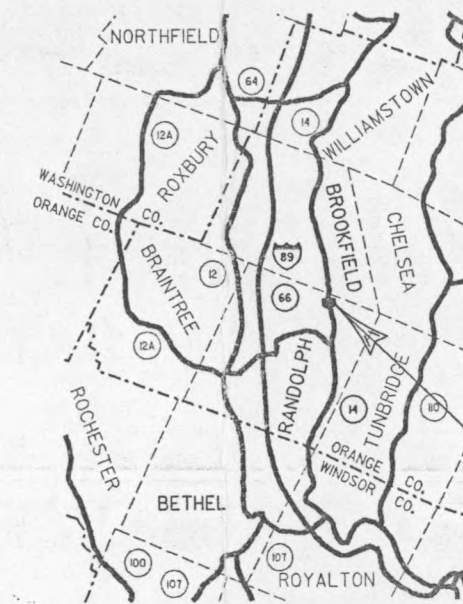

0 5 10
SCALE IN MILES

TRAFFIC DATA
1993 ADT = 910
1993 DHV = 125
2013 ADT = 1250
2013 DHV = 175
%T = 8
%D = 51
V = 50 MPH

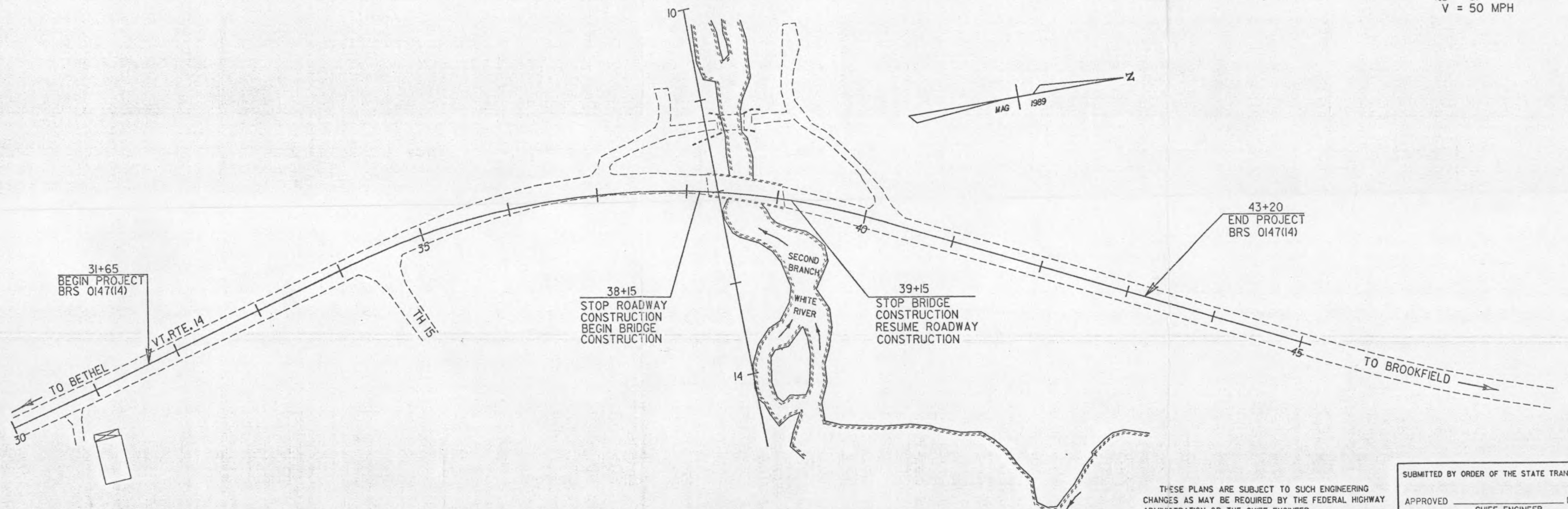

CONVENTIONAL SIGNS

COUNTY LINE	---
TOWN LINE	---
LIMITS OF ACCESS	---o---
POINT OF ACCESS	X
FENCE LINE	-x-x-
STONE WALL	oooo
TRAVELED WAY	----
GUARD RAIL	o-o-o-o
RAILROAD	
SURVEY LINE	---
CULVERT	---
POWER POLE	o
TELEPHONE POLE	o
TREES	* *
CONTROL OF ACCESS	///
PROPERTY LINE	---
R.O.W. TAKING LINE	SR
SLOPE RIGHTS	o
TOP OF CUT	o
TOE OF SLOPE	o

DATUM
VERTICAL N/A
HORIZONTAL NGVD 1929

0 60 120
SCALE IN FEET

THESE PLANS ARE SUBJECT TO SUCH ENGINEERING
CHANGES AS MAY BE REQUIRED BY THE FEDERAL HIGHWAY
ADMINISTRATION OR THE CHIEF ENGINEER.
CONSTRUCTION IS TO BE CARRIED ON IN ACCORDANCE
WITH THESE PLANS AND THE STANDARD SPECIFICATIONS
FOR CONSTRUCTION DATED 1986, AS APPROVED BY THE
FEDERAL HIGHWAY ADMINISTRATION ON NOVEMBER 21, 1985
FOR USE ON THIS PROJECT, INCLUDING ALL SUBSEQUENT
REVISIONS AND SUCH REVISED SPECIFICATIONS AND
SPECIAL PROVISIONS AS ARE INCORPORATED IN THESE
PLANS.

SUBMITTED BY ORDER OF THE STATE TRANSPORTATION BOARD	
APPROVED _____	DATE _____
CHIEF ENGINEER	
DEPARTMENT OF TRANSPORTATION FEDERAL HIGHWAY ADMINISTRATION	
APPROVED _____	DATE _____
DIVISION ADMINISTRATOR	
PROJECT RANDOLPH BRS 0147(14)	
SHEET 1 OF SHEETS	

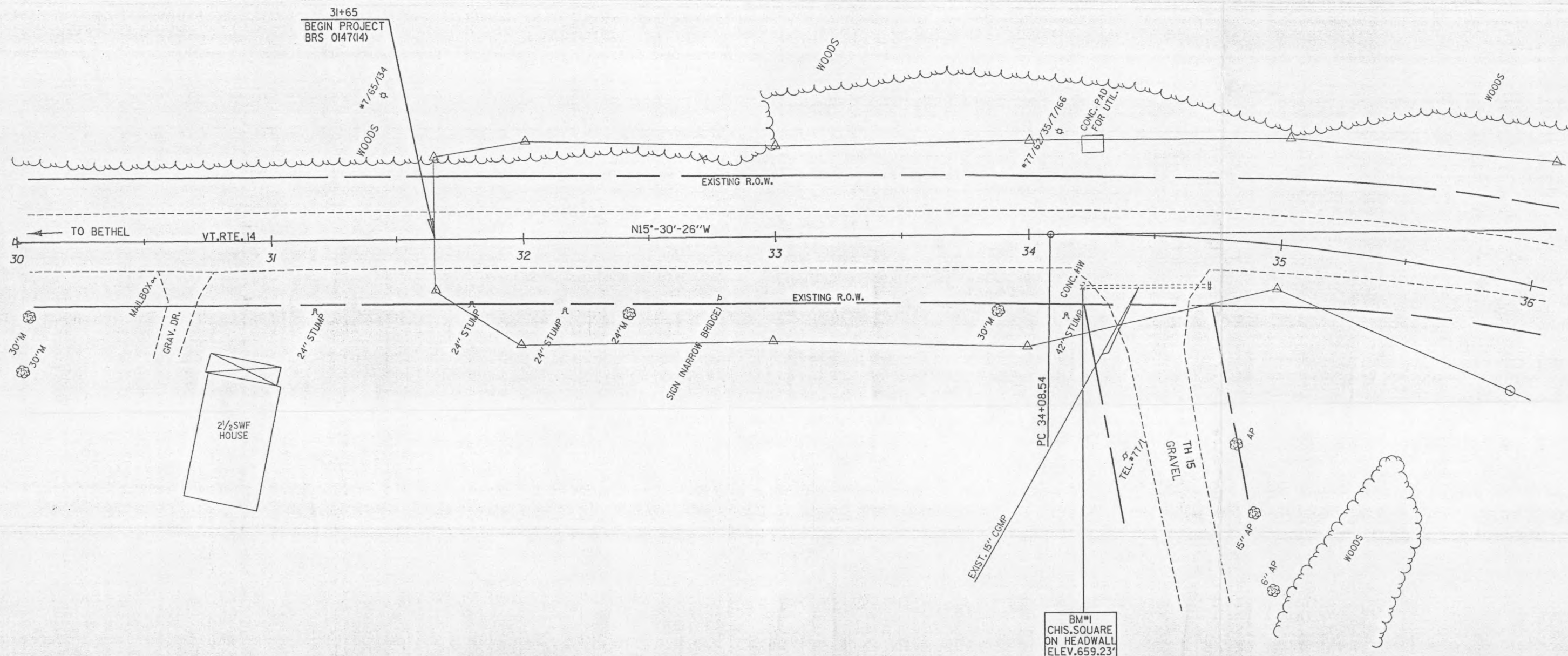
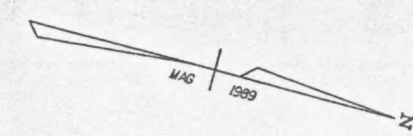

DATUM	
VERTICAL	N/A
HORIZONTAL	NGVD 1929

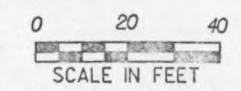

SURVEYED BY	SHERIDAN	DATE	11/89
DRAWN BY	MCCLURE	DATE	11/89
SQUAD LEADER	BOYD		
DESIGN FILE NO.	ZG045054185E033RAN		
PRF FILE	85E033LI	DATE PLOTTED	12/89
PROJ. NAME	RANDOLPH		
PROJ. NO.	BRS0147(14)		
SHEET	5	OF	SHEETS

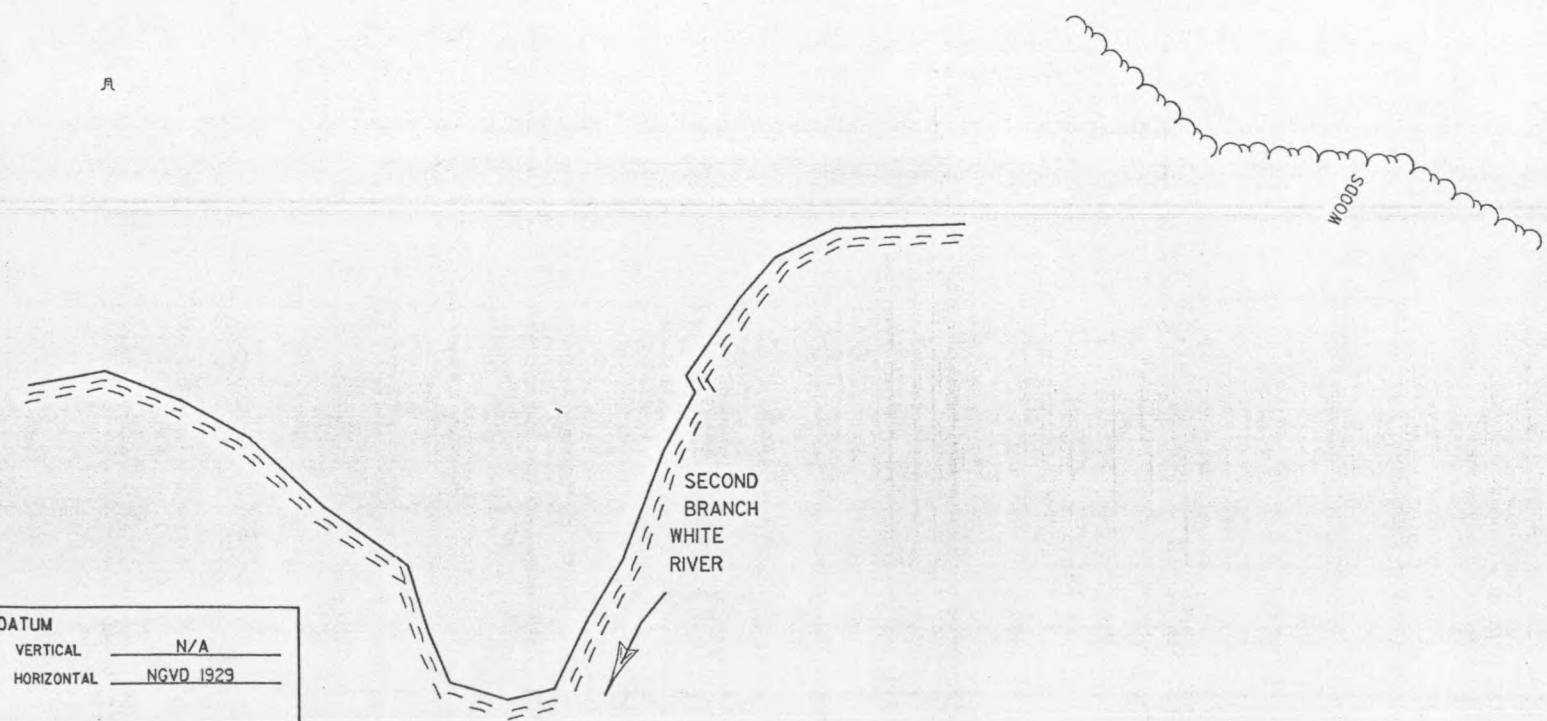
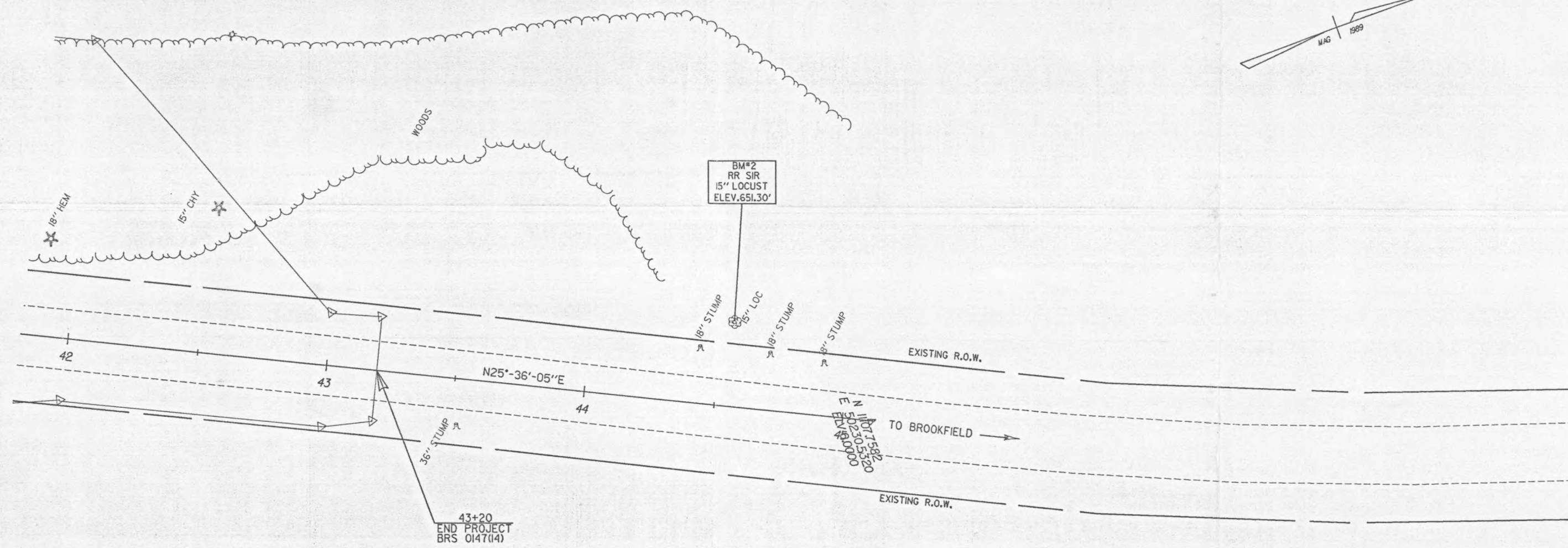
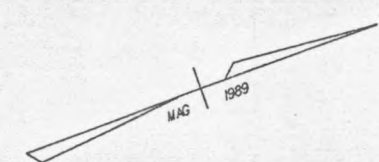

DATUM	
VERTICAL	N/A
HORIZONTAL	NGVD 1929

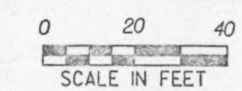

SURVEYED BY	SHERIDAN	DATE	11/88
DRAWN BY	MCCLURE	DATE	11/89
SQUAD LEADER	BOYD		
DESIGN FILE NO.	ZG0450,54185E033RAN		
PRF FILE	85E03313	DATE PLOTTED	1/90
PROJ. NAME	RANDOLPH		
PROJ. NO.	BRS0147(14)		
SHEET	9	OF	SHEETS

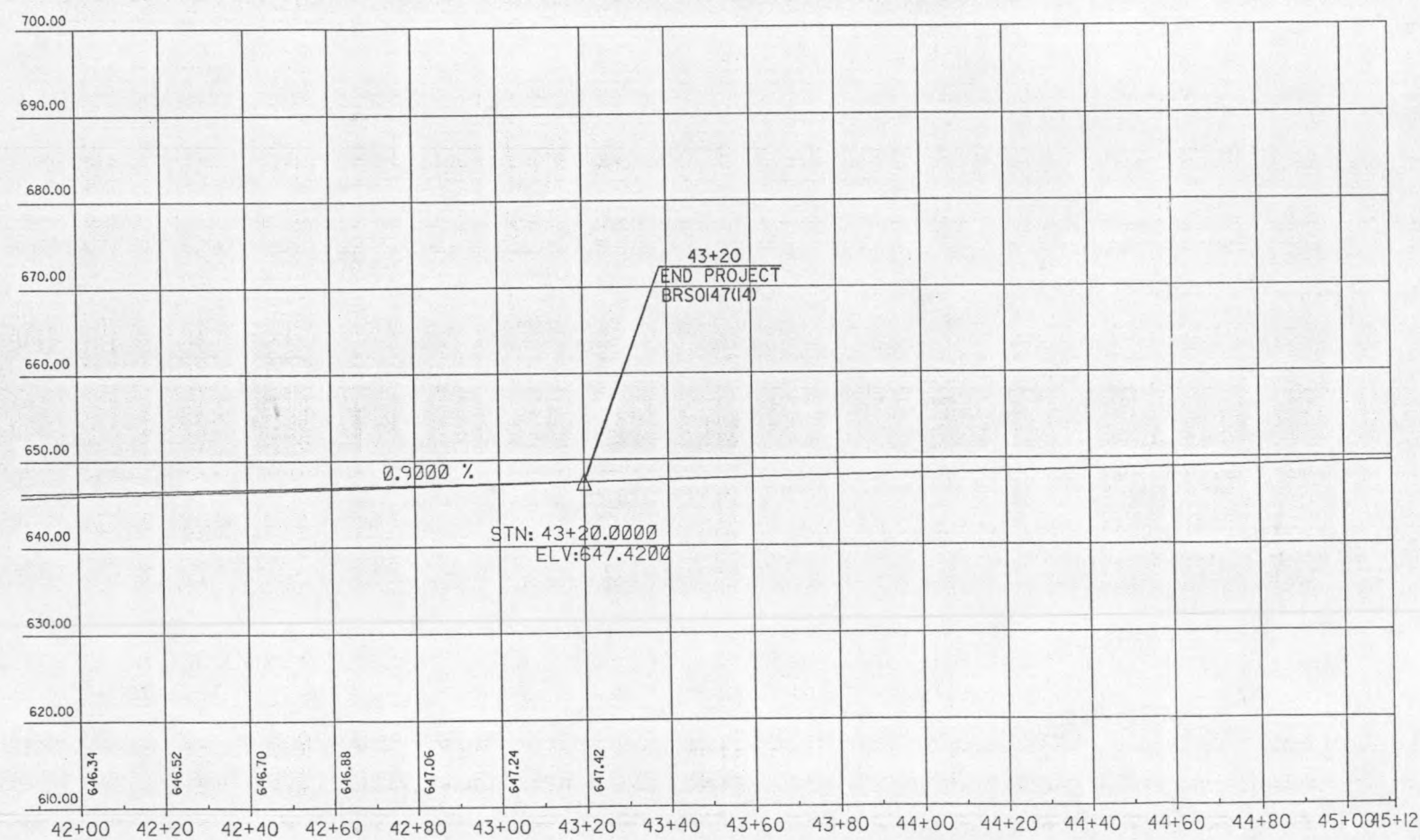

SCALES IN FEET

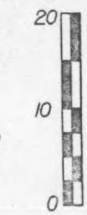
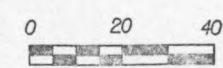

SURVEYED BY	SHERIDAN	DATE	11/88
DRAWN BY	MCCLURE	DATE	11/89
SQUAD LEADER	BOYD		
DESIGN FILE NO.	ZG0450,54185E033RAN		
PRF	85E033P3	DATE	1/90
FILE		PLOTTED	
PROJ. NAME	RANDOLPH		
PROJ. NO.	BRS0147(14)		
SHEET	10	OF	SHEETS

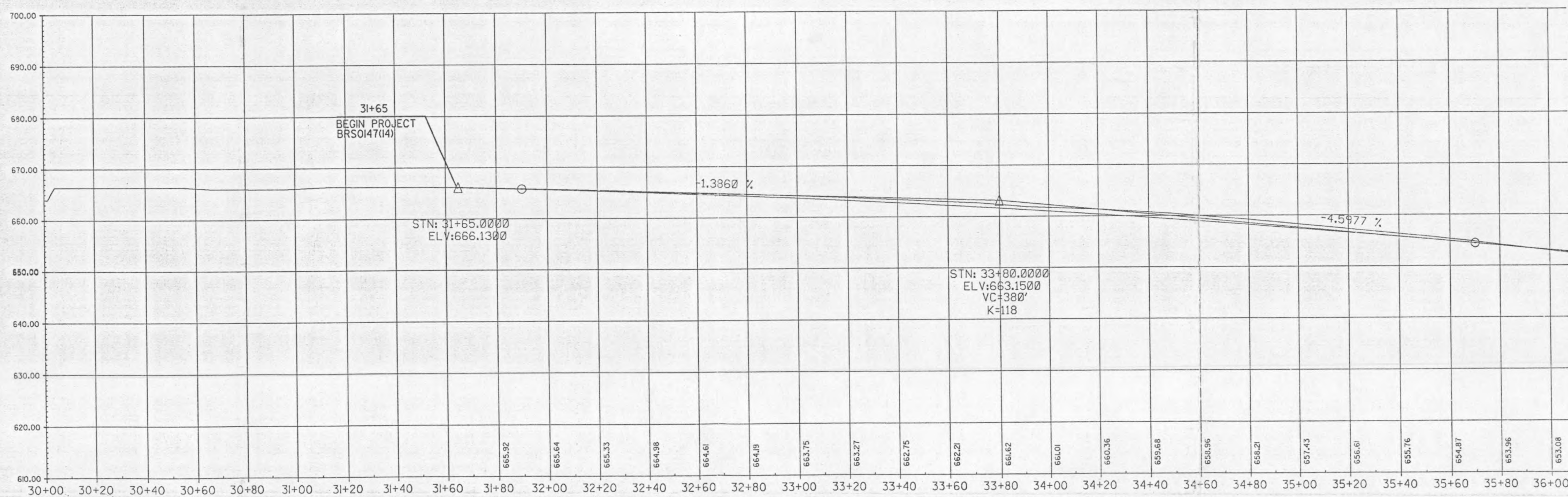

SCALES IN FEET

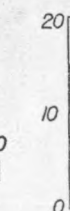
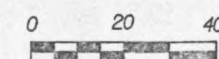

SURVEYED BY	SHERIDAN	DATE	11/88
DRAWN BY	MCCLURE	DATE	11/89
SQUAD LEADER	BOYD		
DESIGN FILE NO.	ZG0450,54185E033RAN		
PRF FILE	85E033PI	DATE PLOTTED	1/90
PROJ. NAME	RANDOLPH		
PROJ. NO.	BRS0147(14)		
SHEET	6	OF	SHEETS

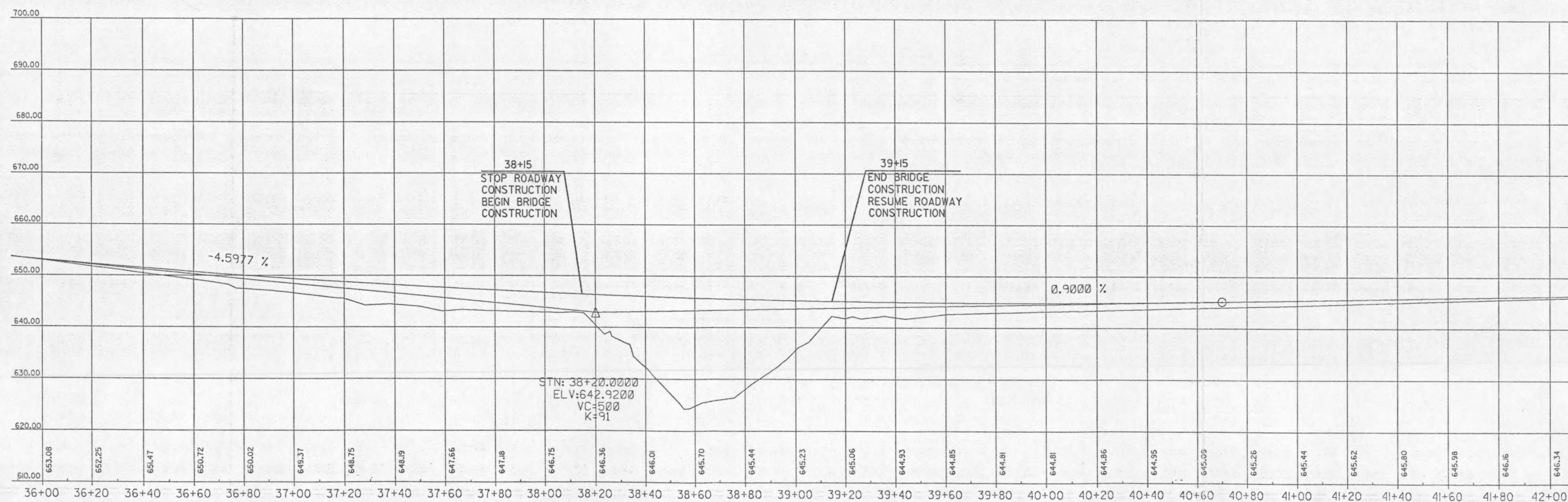

SCALES IN FEET

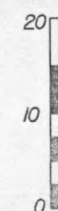
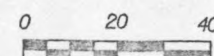

SURVEYED BY	SHERIDAN	DATE	11/88
DRAWN BY	MCCLURE	DATE	11/89
SQUAD LEADER	BOYD		
DESIGN FILE NO.	ZG0450,54105E033RAN		
PRF FILE	85E033P2	DATE PLOTTED	1/90
PROJ. NAME	RANDOLPH		
PROJ. NO.	BR0147(14)		
SHEET 8	OF	SHEETS	

SEEDING FORMULA , ITEM 651.10
RURAL AREAS

2 1/2" BITUMINOUS CONCRETE PAVEMENT (TWO 1 1/4" LIFTS, TYPE III)
4" BASE COURSE OF BITUMINOUS CONCRETE PAVEMENT, TYPE I
24" SUBBASE OF GRAVEL
12" SAND BORROW

SHOULDERS : 1 1/4" BITUMINOUS CONCRETE PAVEMENT, TYPE III

12" TO 24" SAND BORROW (IN CUTS) } AS INDICATED ON THE PLANS OR
AS DIRECTED BY THE ENGINEER

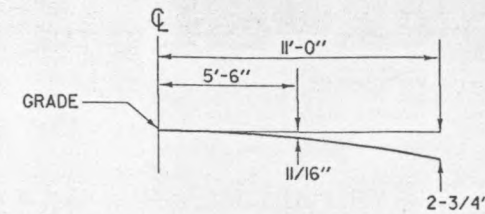

PARABOLIC DETAIL

<u>% WT.</u>	<u>LBS./A.</u>	<u>NAME</u>	<u>PUR %</u>	<u>GERM %</u>
3.33	2	CROWN VETCH	97	75
50.00	30	CREeping RED FESCUE	98	85
8.33	5	TIMOTHY	99	85
16.67	10	PERENNIAL RYE GRASS (VAR.PENNFINE)	95	85
8.34	5	ALFAFA (VAR. SARANAC)	99	85
8.33	5	BIRDFOOT TREFOIL(VAR.EMPIRE)	98	85
5.00	3	HIGHLAND BENT GRASS	92	85
<u>100.00</u>	<u>60</u>			

THE SEED MIXTURE SHALL NOT HAVE A WEED CONTENT EXCEEDING 0.40% BY WEIGHT AND SHALL BE FREE OF ALL NOXIOUS WEED SEED.

SEED- TO BE APPLIED PER SEEDING FORMULAS DIRECTED BY THE ENGINEER.

FERTILIZER- FORMULA 10-20-10 TO BE USED WITH SEED, APPLIED AT THE RATE OF 500 LBS./ACRE.

AGRICULTURAL LIMESTONE- TO BE APPLIED AT THE RATE OF 2 TONS/ACRE
OR AS DIRECTED BY THE ENGINEER.

HAY MULCH- TO BE PLACED ON EARTH SLOPES AT THE RATE OF 2 TONS/ACRE,
OR AS DIRECTED BY THE ENGINEER.

TOPSOIL- TO BE USED WITH SEED AS INDICATED ON THE PLANS,
OR AS DIRECTED BY THE ENGINEER.

MARKER POSTS- TO BE PLACED AS DIRECTED BY THE ENGINEER.

SLOPE ROUNDING- ALL CUT SLOPES TO BE ROUNDED IN ACCORDANCE WITH STANDARD SHEET B-5.

PAY LIMITS OF SAND BORROW WHEN USED IN CONJUNCTION WITH UNDERDRAIN- SEE STANDARD SHEET D-2.

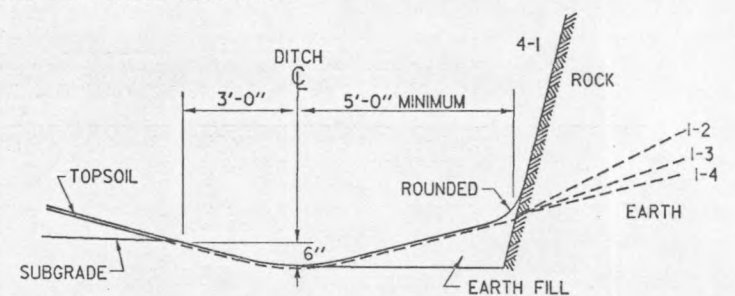

DETAILS OF DITCH AND BACKSLOPE FOR
LOW SIDE OF BANK < 0.042 FT/FT

FOR SLOPES IN SOLID ROCK EXCAVATION
AND DRILLING AND BLASTING OF SOLID
ROCK SUBGRADE, SEE STANDARD SHEET A-60.

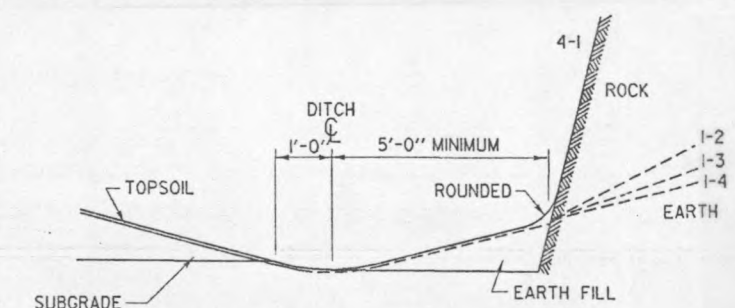

DETAILS OF DITCH AND BACKSLOPE FOR
LOW SIDE OF BANK ≥ 0.042 FT/FT

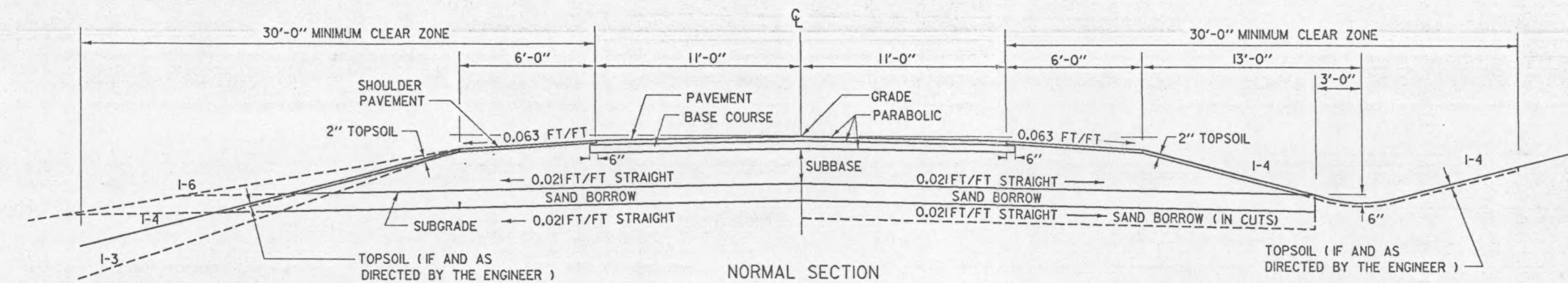

NORMAL SECTION

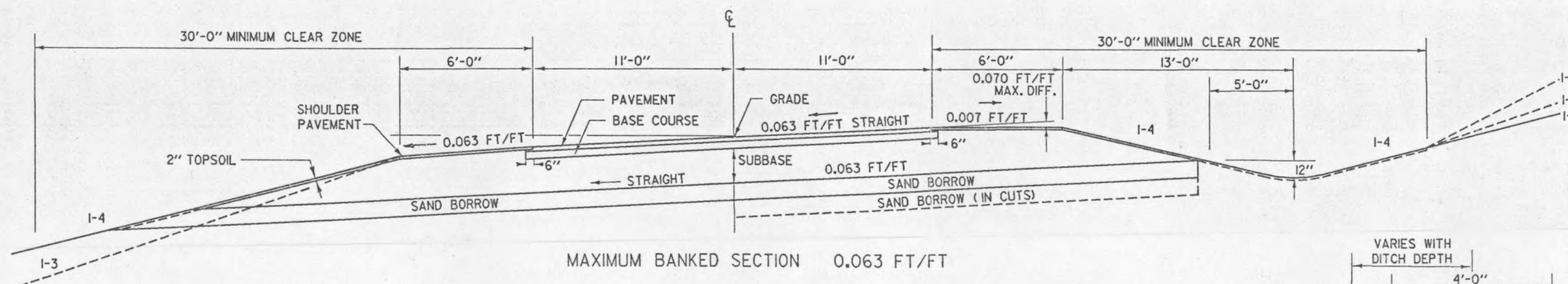

MAXIMUM BANKED SECTION 0.063 FT/FT

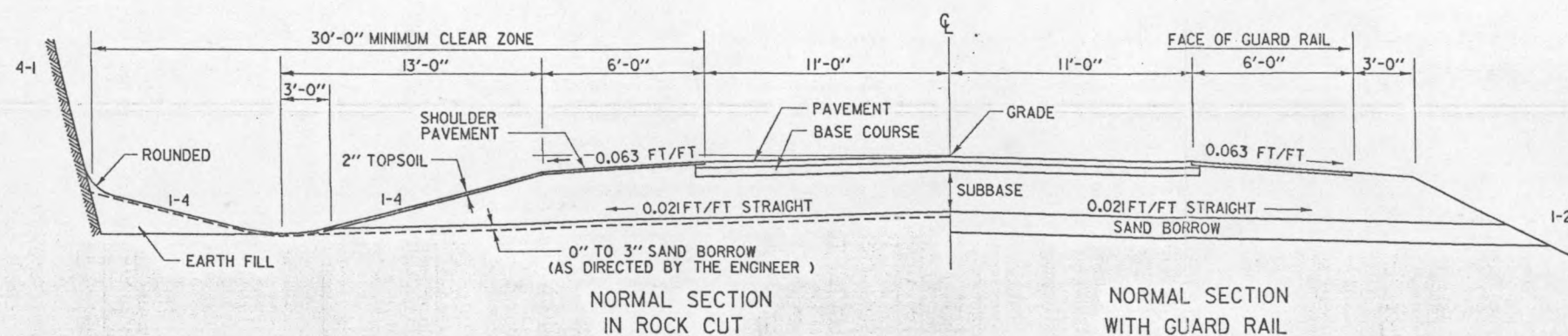

NORMAL SECTION
IN ROCK CUT

NORMAL SECTION
WITH GUARD RAIL

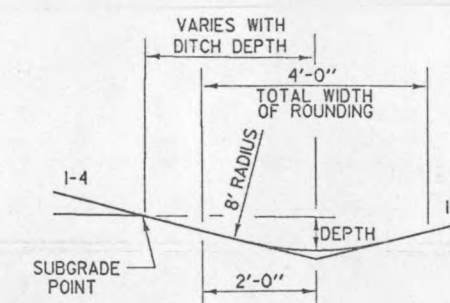

TYPICAL DITCH DETAILS

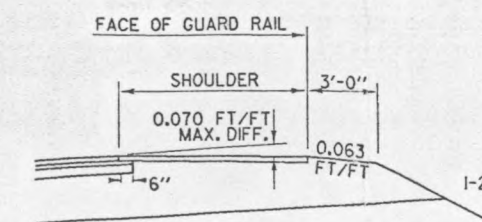

DETAIL OF GUARD RAIL ON HIGH
SIDE OF BANKED SECTION

DRAWN BY MCCLURE DATE 12/89
SQUAD LEADER BOYD
DESIGN FILE NO. ZG0150.541B5E033FRM
PRF DATE
FILE 85E033TYP PLOTTED 1/90
PROJ. NAME RANDOLPH
PROJ. NO. BRS 0147(14)
SHEET 2 OF SHEETS

